

FIRE BARRIER SYSTEM

Wall to Wall | Corner & Ceiling to Wall

25 - 500 mm (1 - 20") Expansion Gaps

FireFlex 2200 : A07-A09

FireFlex 2200 : A07

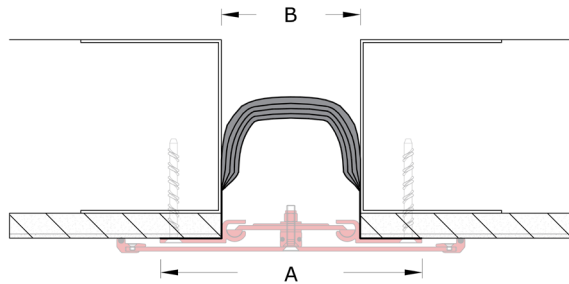

FireFlex 2200 : A09

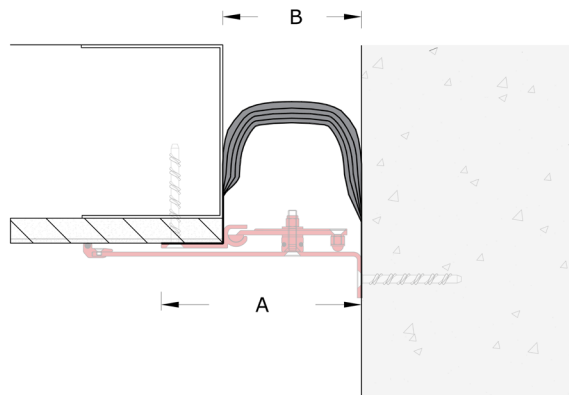

Fire Barrier Selection Criteria

Load Rating

Product Details

Joint Location	Gap Width B (mm)	Movement Capacity (mm)		Eurocode Rating				Product Dimensions			Product Number	
		±	[Total]					Height H1 (mm) H2 (mm)	Sightline A (mm)	Blockout C (mm)		
2 Hour Fire Rated (120 mins)												
Wall - Wall Ceiling - Ceiling	25	± 12	[25]							95		2200-A07-025-2
	50	± 25	[50]							120		2200-A07-050-2
	75	± 37	[75]							145		2200-A07-075-2
	100	± 50	[100]							170		2200-A07-100-2
	125	± 62	[125]							195		2200-A07-125-2
	150	± 75	[150]							220		2200-A07-150-2
	200	± 100	[200]	-	-	-	-	-	-	270	-	2200-A07-200-2
	250	± 125	[250]							320		2200-A07-250-2
	300	± 150	[300]							370		2200-A07-300-2
	350	± 175	[350]							420		2200-A07-350-2
	400	± 200	[400]							470		2200-A07-400-2
	450	± 225	[450]							520		2200-A07-450-2
	500	± 250	[500]							570		2200-A07-500-2
2 Hour Fire Rated (120 mins)												
Corner - Wall Ceiling - Wall	25	± 12	[25]							60		2200-A09-025-2
	50	± 25	[50]							85		2200-A09-050-2
	75	± 37	[75]							110		2200-A09-075-2
	100	± 50	[100]							135		2200-A09-100-2
	125	± 62	[125]							160		2200-A09-125-2
	150	± 75	[150]							185		2200-A09-150-2
	200	± 100	[200]	-	-	-	-	-	-	235	-	2200-A09-200-2
	250	± 125	[250]							285		2200-A09-250-2
	300	± 150	[300]							335		2200-A09-300-2
	350	± 175	[350]							385		2200-A09-350-2
	400	± 200	[400]							435		2200-A09-400-2
	450	± 225	[450]							485		2200-A09-450-2
	500	± 250	[500]							535		2200-A09-500-2

Features

Movement

High movement capacity

ASTM E-1399 Class I: Thermal
 Class II: Wind

Material

High-temperature refractory ceramic fibre

Stainless steel foil sheath

Traffic Frequency per day

				
-	-	-	-	-

System Options

Gap width(s)	25, 50, 75, 100, 125, 150, 200, 250, 300, 350, 400, 450, 500 mm
Height(s)	Not applicable
Metal type(s):	Stainless Steel foil
Colour(s)	Stainless Steel sheath
Fire barrier	UL 2079: 120 minutes
Waterproofing	Waterproofing membrane
Pre-assembly in factory	Contact Vexcolt

FireFlex 2200 : A07-A09

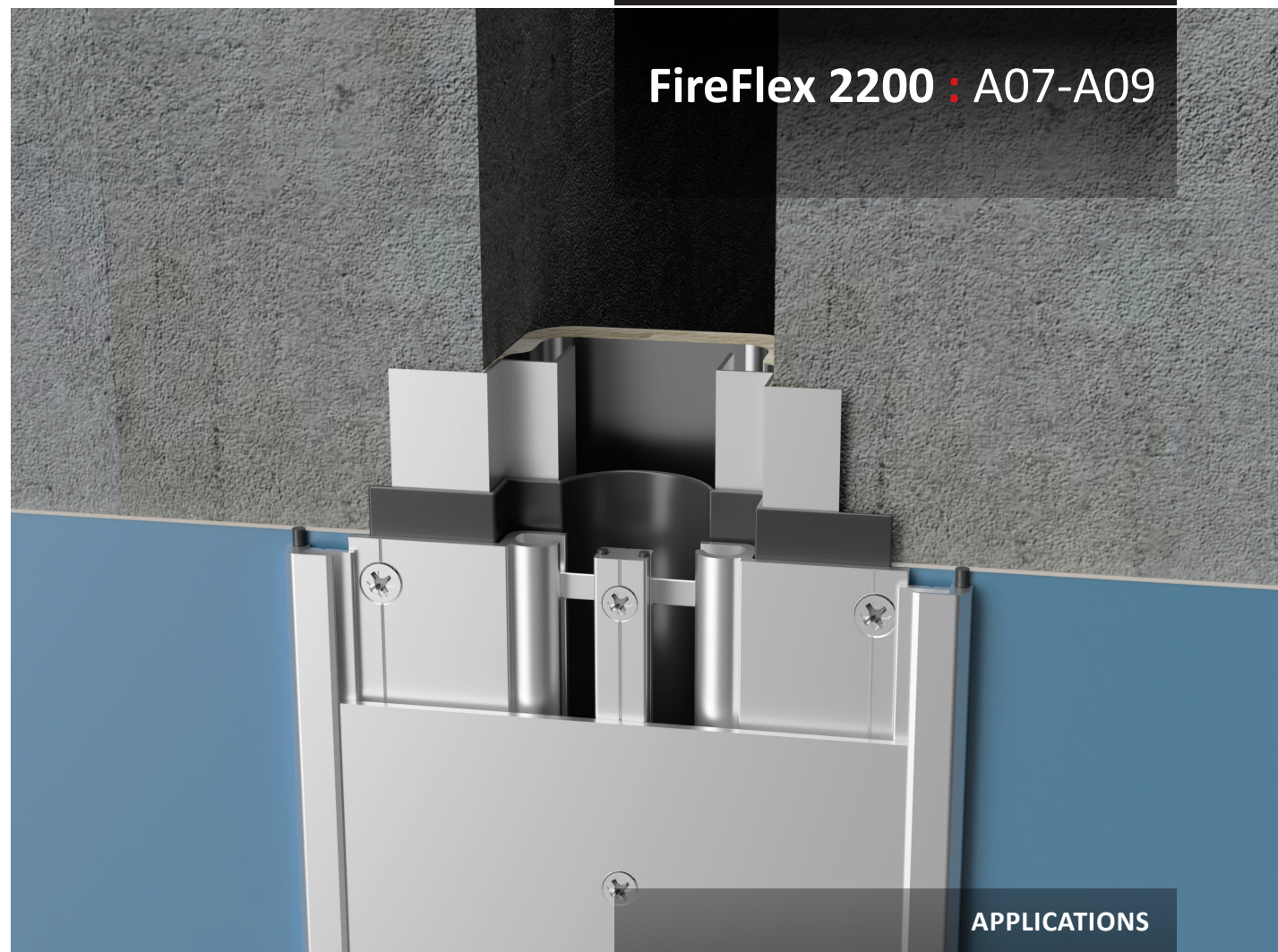

APPLICATIONS

Airport Terminals | Educational | Exhibition Centres
 Department Stores | Distribution & Retail Warehouses
 Factories | Hospitals | Museums | Offices & Hotels
 Parking | Places of Worship | Residential Buildings
 Rail, Metros & Elevated Rail Stations | Roads & Bridges
 Shopping Centres | Sports Stadiums | Supermarkets