

FIRE BARRIER SYSTEM

Wall to Wall | Corner to Wall

25 - 100 mm (1 - 4") Expansion Gaps

FireFlex 2500 : A07-A09

FireFlex 2500 : A07

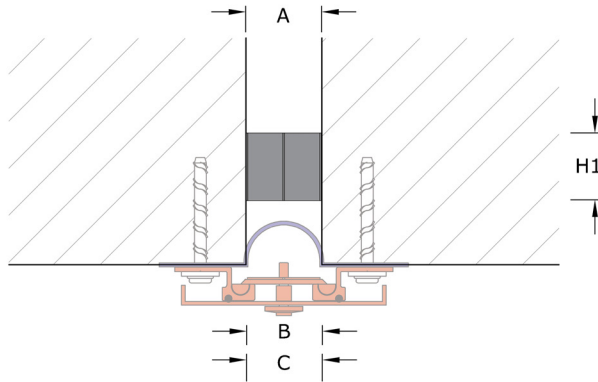

FireFlex 2500 : A09

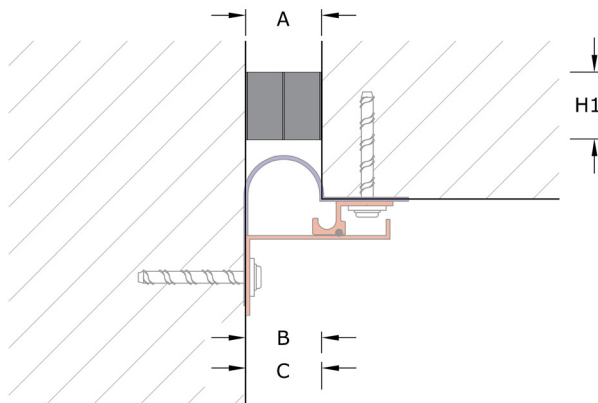

Fire Barrier Selection Criteria

Load Rating

Product Details

Joint Location	Gap Width B (mm)	Movement Capacity (mm)		Eurocode Rating				Product Dimensions		Sightline A (mm)	Blockout C (mm)	Product Number
		±	[Total]					H1 (mm)	H2 (mm)			
2 Hour (120 mins) Fire Rated Integrity												
Wall - Wall	25	± 12	[25]	-	-	-	-	20	-	25	25	2500-A07-025-2
	35	± 17	[35]					35		35	2500-A07-035-2	
	50	± 25	[50]					50		50	2500-A07-050-2	
	75	± 37	[75]					75		75	2500-A07-075-2	
	100	± 50	[100]					100		100	2500-A07-100-2	
Corner - Wall	25	± 12	[25]	-	-	-	-	20	-	25	25	2500-A09-025-2
	35	± 17	[35]					35		35	2500-A09-035-2	
	50	± 25	[50]					50		50	2500-A09-050-2	
	75	± 37	[75]					75		75	2500-A09-075-2	
	100	± 50	[100]					100		100	2500-A09-100-2	

Features

Movement

Easy to install

High movement capacity ± 50 mm

ASTM E-1399 Class I: Thermal

Class II: Wind

Material

Intumescent Thermoplastic filled with flame retardants and binders

Tests

BS 476pt 20/22 - Fire Resistance - 120 minutes fireproofing integrity

EN 10140-2: 2010 - Acoustic Rating

EN 1026: 2000 - Air Permeability

Traffic Frequency per day



- - - - -

System Options

Gap width(s)	25, 35, 50, 75, 100 mm
Height(s)	Not applicable
Metal type(s):	None
Colour(s)	Black
Fire barrier	BS 476: 120 minutes fireproofing integrity
Waterproofing	Waterproofing membrane
Pre-assembly in factory	Contact Vexcolt

FireFlex 2500 : A07-A09

APPLICATIONS

Airport Terminals | Educational | Exhibition Centres
 Department Stores | Distribution & Retail Warehouses
 Factories | Hospitals | Museums | Offices & Hotels
 Parking | Places of Worship | Residential Buildings
 Rail, Metros & Elevated Rail Stations | Roads & Bridges
 Shopping Centres | Sports Stadiums | Supermarkets